

NEWFIELD EXPLORATION COMPANY

PROPOSED ROAD RIGHT-OF-WAY
& SURFACE USE AREA
ON FEE LANDS
(For the 3-19-3-3WH Well Pad)

Located in
Sections 18 & 19, T3S, R3W, U.S.B.&M.
Duchesne County, Utah

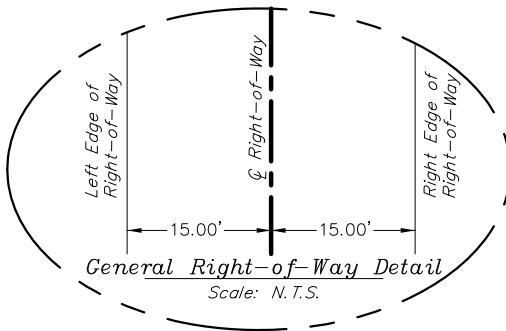
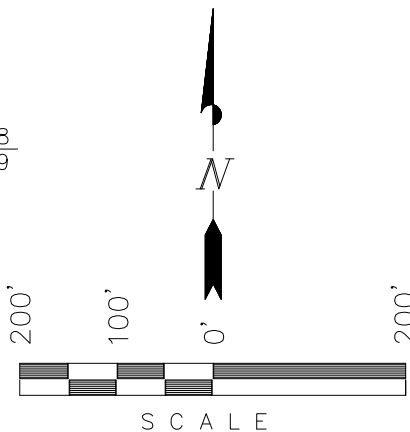

CERTIFICATE

THIS IS TO CERTIFY THAT THE ABOVE PLAT WAS PREPARED FROM FIELD NOTES OF ACTUAL SURVEYS MADE BY ME OR UNDER MY DIRECT SUPERVISION AND THAT THE SAME ARE TRUE AND CORRECT TO THE BEST OF MY KNOWLEDGE AND BELIEF

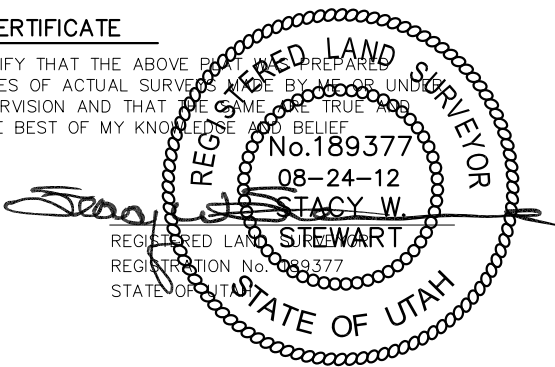

Sec. 19

Southeast Corner
NE 1/4 NW 1/4
Section 19
(Plastic Cap on
Rebar)

1/16 Section Line

SURVEYED BY: C.S.

DRAWN BY: L.K.

DATE: 08-24-12

SCALE: 1" = 200'

DWG #: 12-0543

Tri State
Land Surveying, Inc.

(435) 781-2501

180 NORTH VERNAL AVE. - VERNAL, UTAH 84078

CORNER TIE NOTE:

Beginning Sta. 0+00 bears
N23°31'27"W 483.67' from the
South 1/4 Corner of Section 18.

Sec. 18

BEGINNING OF PROPOSED
ROAD RIGHT-OF-WAY
STA. 0+00
(At Existing Road for the
3-20-3-3WH Well Pad)

N87°48'24"E - 2580.68' (Meas.)
(Basis of Bearings)

Section Line/Property Line

CORNER TIE NOTE:

The Northeast corner (Point of
Beginning) of the Surface Use Area
bears S86°28'26"W 1074.77' from the
North 1/4 Corner of Section 19.

SURFACE USE AREA
3-19-3-3WH
(Contains 5.306 Acres)

RIGHT-OF-WAY LENGTHS

ALPINE PARTNERS, SECTION 18	= 1,142.03'
SCRATCH, SECTION 18	= 482.50'
TAYLOR, SECTION 19	= 383.59'
TOTAL	= 2,008.12'

ROAD RIGHT-OF-WAY DESCRIPTION

A 30' WIDE RIGHT-OF-WAY LOCATED IN SECTIONS 18 & 19, T3S, R3W, U.S.B.&M. THE WIDTH OF SAID RIGHT-OF-WAY BEING 15' ON EACH SIDE OF THE CENTERLINE. THE CENTERLINE OF SAID RIGHT-OF-WAY BEING MORE PARTICULARLY DESCRIBED AS FOLLOWS:

BEGINNING AT A POINT IN THE SE 1/4 SW 1/4 OF SECTION 18, T3S, R3W, U.S.B.&M. WHICH BEARS N23°31'27"W 483.67' FROM THE SOUTH 1/4 CORNER OF SAID SECTION 18, THENCE S87°15'41"W 435.75'; THENCE S81°54'05"W 150.02'; THENCE S85°33'26"W 150.05'; THENCE S80°55'00"W 149.97'; THENCE S75°51'39"W 150.19'; THENCE S86°46'44"W 149.22'; THENCE S52°09'12"W 73.99'; THENCE S23°08'55"W 365.34'; TO A POINT ON THE NORTH LINE OF THE NW 1/4 OF SECTION 19, T3S, R3W, U.S.B.&M. WHICH BEARS N87°48'24"E 1008.35' FROM THE NORTHWEST CORNER OF SAID SECTION 19; THENCE S23°08'55"W 78.72'; THENCE S04°03'34"W 150.15'; THENCE S34°47'43"E 149.85'; THENCE S53°40'55"E 4.87' TO A POINT IN LOT 1 OF SAID SECTION 19 WHICH BEARS S73°39'25"E 1099.91' FROM THE SAID NORTHWEST CORNER OF SECTION 19. THE SIDE LINES OF SAID DESCRIBED RIGHT-OF-WAY BEING SHORTENED OR ELONGATED TO MEET THE GRANTOR'S PROPERTY LINES. BASIS OF BEARINGS IS THE NORTH LINE OF THE NW 1/4 OF SAID SECTION 19 WHICH IS TAKEN FROM GLOBAL POSITIONING SATELLITE OBSERVATIONS TO BEAR N87°48'24"E A MEASURED DISTANCE OF 2580.68'. CONTAINS 1.383 ACRES MORE OR LESS.

CORNER TIE NOTE:

End Sta. 20+08.12 bears
S73°39'25"E 1099.91' from the
Northwest Corner of
Section 19.

END OF PROPOSED
ROAD RIGHT-OF-WAY
STA. 20+08.12
(At Surface Use Area)

SURFACE USE AREA DESCRIPTION

BEGINNING AT A POINT IN THE NE 1/4 NW 1/4 OF SECTION 19, T3S, R3W, U.S.B.&M. WHICH BEARS S86°28'26"W 1074.77' FROM THE NORTH 1/4 CORNER OF SAID SECTION 19, THENCE S33°04'45"E 332.31'; THENCE S56°54'24"W 562.65'; THENCE N33°24'21"W 421.84'; THENCE N56°55'08"E 415.58'; THENCE N87°48'25"E 174.17' TO THE POINT OF BEGINNING. BASIS OF BEARINGS IS THE NORTH LINE OF THE NW 1/4 OF SAID SECTION 19 WHICH IS TAKEN FROM GLOBAL POSITIONING SATELLITE OBSERVATIONS TO BEAR N87°48'24"E A MEASURED DISTANCE OF 2580.68'. CONTAINS 5.306 ACRES MORE OR LESS.

LEGEND



= SECTION CORNERS FOUND

P.I. = POINT OF INTERSECTION

P.O.S.L. = POINT ON SECTION LINE

P.O.P.L. = POINT ON PROPERTY LINE

--- = UTILITY LINE

(For the 3-19-3-3WH Well Pad)

(At Proposed Pipeline for
the 3-20-3-3WH Well Pad)

Centerline of
Proposed Pipeline
Right-of-Way \

LEGEND

P.I. = POINT OF INTERSECTION
P.O.S.L. = POINT ON SECTION LINE
P.O.P.L. = POINT ON PROPERTY LINE
- - - = FIBER OPTIC LINE
- - - - - = DRAINAGE/IRRIGATION

RIGHT-OF-WAY LENGTHS

TAYLOR, SECTION 19	=	451.30'
SCRATCH, SECTION 18	=	512.32'
ALPINE PARTNERS, SECTION 18	=	1,520.82'
TOTAL	=	2,484.44'

THIS IS TO CERTIFY THAT THE ABOVE REPORT WAS PREPARED
FROM FIELD NOTES OF ACTUAL SURVEYS MADE BY ME OR UNDER
MY DIRECT SUPERVISION AND THAT THE SAME ARE TRUE AND
CORRECT TO THE BEST OF MY KNOWLEDGE AND BELIEF

REGISTRATION No. 189377
08-24-12
STACY W
STEWART
REGISTERED LAND SURVEYOR
REGISTRATION No. 189377
STATE OF UTAH

Southeast Corner
 NE 1/4 NW 1/4
 Section 19
 (Plastic Cap on
 Rebar)

1/16 Section Line

A 30' WIDE RIGHT-OF-WAY LOCATED IN SECTIONS 18 & 19, T3S, R3W, U.S.B.&M. THE WIDTH OF SAID RIGHT-OF-WAY BEING 15' ON EACH SIDE OF THE CENTERLINE. THE CENTERLINE OF SAID RIGHT-OF-WAY BEING MORE PARTICULARLY DESCRIBED AS FOLLOWS:

BEGINNING AT A POINT IN LOT 1 OF SECTION 19, T3S, R3W, U.S.B.&M. WHICH BEARS S71°55'02"E 1141.36' FROM THE NORTHWEST CORNER OF SAID SECTION 19, THENCE N54°57'16"W 58.18'; THENCE N34°50'25"W 155.79'; THENCE N03°03'05"E 157.30'; THENCE N22°51'03"E 80.03' TO A POINT ON THE SOUTH LINE OF SECTION 18, T3S, R3W, U.S.B.&M. WHICH BEARS N87°48'24"E 988.54' FROM THE SOUTHWEST CORNER OF SAID SECTION 18, THENCE N22°51'03"E 374.13'; THENCE N53°36'05"E 96.57'; THENCE N86°46'55"E 144.26'; THENCE N75°52'31"E 147.66'; THENCE N80°57'55"E 156.34'; THENCE N85°34'25"E 147.54'; THENCE N81°53'37"E 152.52'; THENCE N87°13'47"E 378.57'; THENCE S16°05'26"E 200.03'; THENCE S10°47'07"E 187.36'; THENCE N67°48'14"E 48.16' TO A POINT IN THE SE 1/4 SW 1/4 OF SAID SECTION 18 WHICH BEARS N48°10'01"W 154.37' FROM THE SOUTH 1/4 CORNER OF SAID SECTION 18. THE SIDE LINES OF SAID DESCRIBED RIGHT-OF-WAY BEING SHORTENED OR ELONGATED TO MEET THE GRANTOR'S PROPERTY LINES. BASIS OF BEARINGS IS THE NORTH LINE OF THE NW 1/4 OF SAID SECTION 19 WHICH IS TAKEN FROM GLOBAL POSITIONING SATELLITE OBSERVATIONS TO BEAR N87°48'24"E A MEASURED DISTANCE OF 2580.68'. CONTAINS 1.711 ACRES MORE OR LESS.

DWG #: 12-0553

Tri State
Land Surveying, Inc.

\(435) 781-2501

180 NORTH VERNAL AVE. - VERNAL, UTAH 84078

FILE: \\LEWIS\drawings\NEWFIELD 2012\3-19-3-3WH (08-09-12)\dwg\PIPELINE.dwg